

P

PAN FEEDING KICK-OFF 160°



SKIOLDLANDMECO



LESS WORK

PAN FEEDING WITH KICK-OFF 160° (PATENTED)

It is crucial that day-old chicks have the best possible conditions from the start. This requirement is met by the kick-off feeding system which provides centrally controlled overflowing of all pans at the same time. The kick-off feeding is controlled centrally by one single operation for each feed line (rotating the pipe), which is extremely time-saving and more or less eliminates the need for manual work otherwise connected with providing feed on the floor/paper.

As the only system, kick-off provides the possibility of feeding day-old chicks regularly with many small meals. If this has to be done manually it is extremely difficult and time-consuming. With kick-off 0.5 kg of feed is supplied pr. outlet. It is furthermore possible to combine the kick-off feeding with "full overflow" where about 1.3 kg of feed is supplied pr. outlet.

+ 30 G THE FIRST WEEK!

The system stimulates the chicks' curiosity and collectively activates them to seek fresh feed. Experiments have thus shown that chick bodyweight is up to 30 g higher than normal after the first week, when the kick-off system is used.

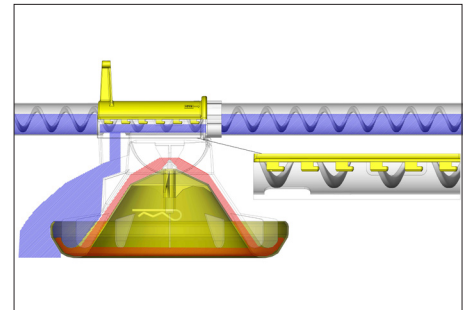
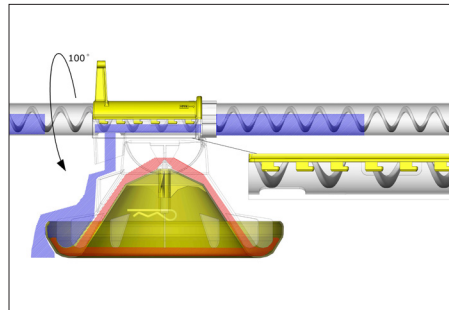
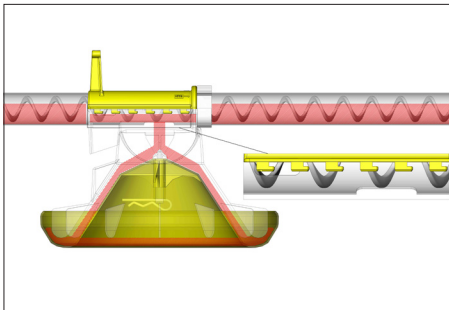

Regular feeding



Kick-off feeding



Full overflow feeding

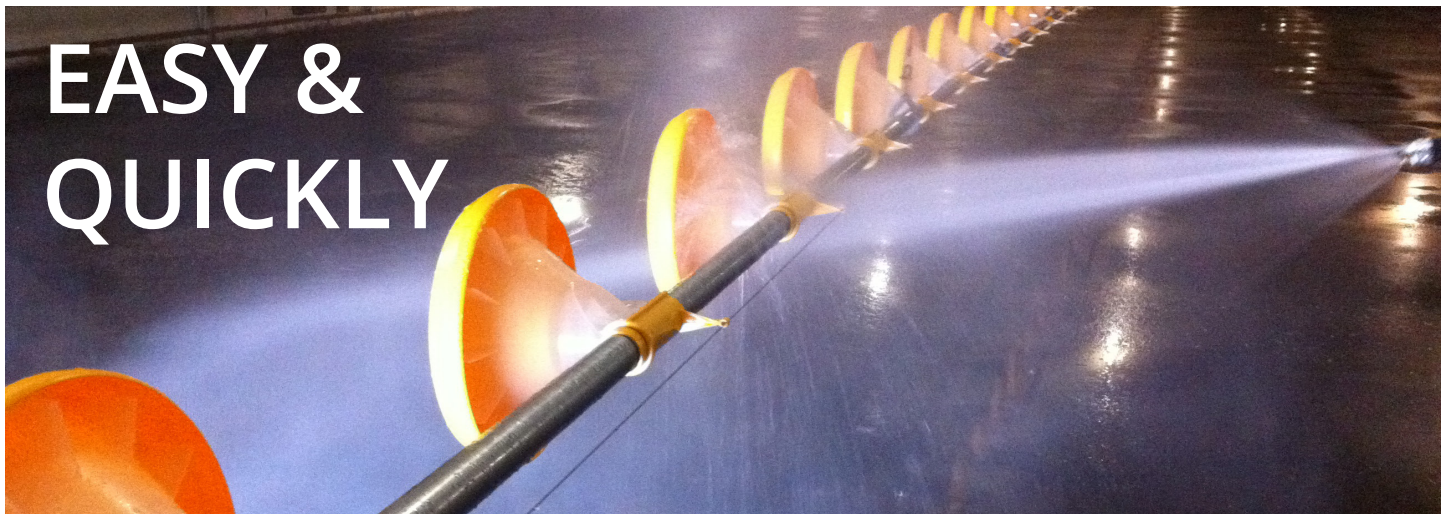

EASY & QUICKLY

EASY-CLEAN (PATENTED)

As the only system, easy-clean provides the possibility of bringing all pans on a feed line into cleaning position by one single operation (central rotation of the pipe). In this position, all outlets are simultaneously closed, thus ensuring that the insides of the pipes remain dry. **SKIOLDLANDMECO's** pans must not be disassembled for cleaning. Easy-clean is extremely time-saving and minimize the manual work which is typically connected to the cleaning process.

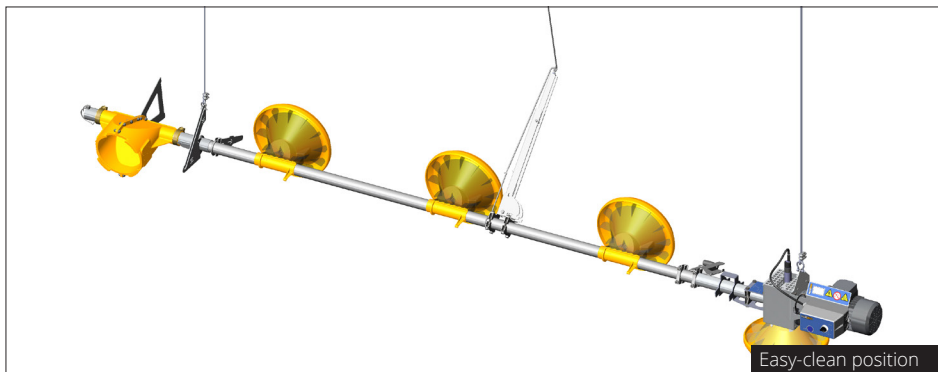
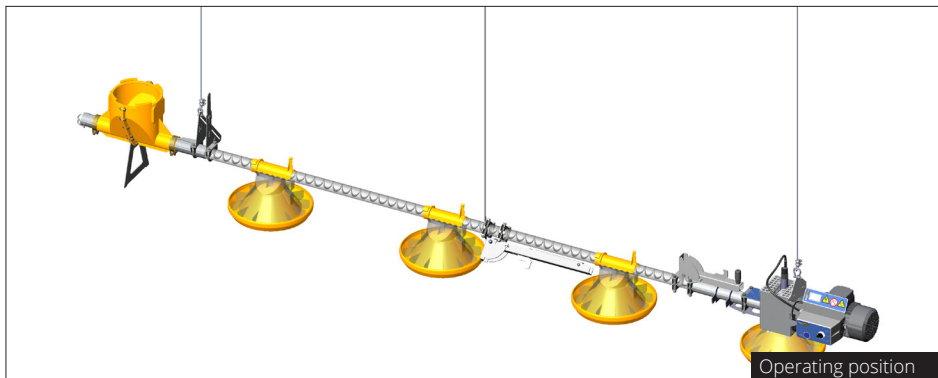

Direct filling (optional)

When using direct filling, the feed lines are filled without having feed hoppers on each separate line. The down pipes are used as the only kind of feed storage.

Having only one feed hopper makes cleaning so much easier, and it also simplifies timing the last feed prior to slaughter. Also, each feed line can start the cross auger individually and thereby avoid the system running empty.

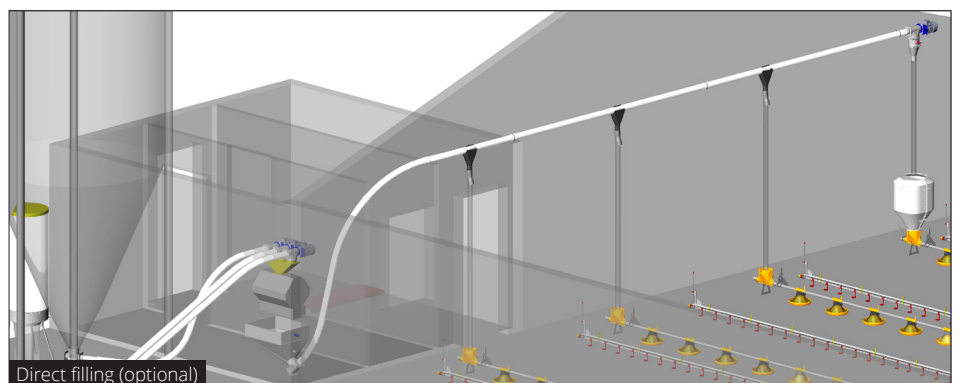

Patent

SKIOLDLANDMECO has the patent on the solution with rotating the feed pipe relative to the feed string and thus the kick-off and easy-clean system.

FACTS

The pan has a low edge (52 mm) which allows the day-old chicks easy access to the feed. Also, the chicks' appetite improves as the feed remains fresher, because there is only app. 900 g feed in the pan. Another benefit is that the pan can be raised from the litter after only a few days.

No feed spillage

The pan was designed on the basis of requirements for no feed spillage. This is ensured by means of the specially designed pan edge and the integrated partitions. The feed is deposited at the correct distance from the pan edge, so that even day-old chicks can reach the feed without having to stand in the pan. This prevents the chicks from contaminating the feed with litter and droppings.

Transparent cone

SKIOLDLANDMECO's pans are with transparent cones, making it easy to see whether the cone and pan are clean. It also makes the quantity of feed in the pan visible, thus providing better conditions for the daily management.

TECHNICAL SPECIFICATIONS

Gearmotor	3 phase 0.37-0.55 kW (230V/400V 50Hz), 1400/300 rpm
	3 phase 0.44-0.66 kW (280V/480V 60Hz), 1600/345 rpm
	1 phase 0.55 kW (230V 50Hz) 1400/300 rpm
	1 phase 0.48 kW (240V 60Hz) 1600/345 rpm CSA
Flex spiral	D 35,4x19x45 mm, 4x8 mm special steel
Feed quantity	App. 5.0 kg/min & 13,5 m/min
Feed pipe	D 45x1,25 mm galvanised steel
Pipe length	5,25 m with 7 pans
Feed hopper	800x520x520 mm with 140 litres & 60° slope
Pan	D 340 mm, circumference 1060 mm, edge height 52 mm
Cone	Transparent plastic with 12 paddles

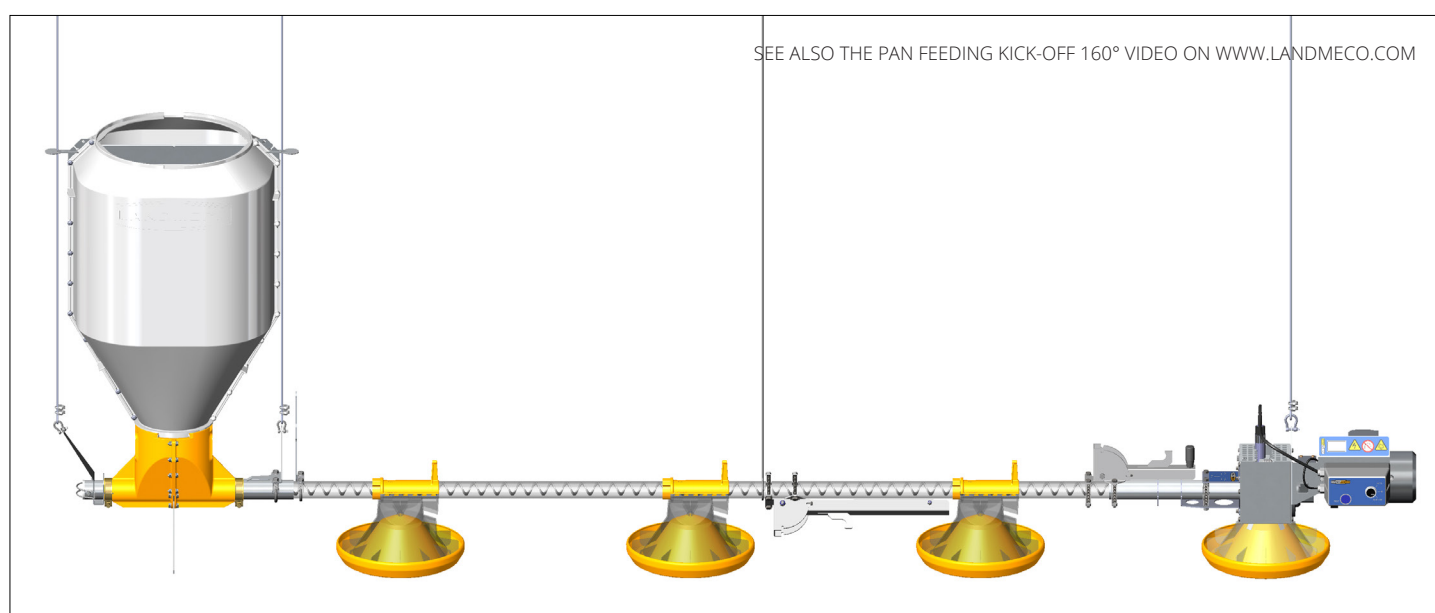

See also **SKIOLDLANDMECO** brochures on, for example:
 (SKIOLDLANDMECO retains the right to alter specifications without notice)



PAN FEEDING
KICK-OFF 330°



DRINKING SYSTEMS



AUGERS



HEATING SYSTEMS

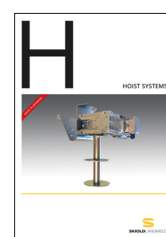

HOIST SYSTEMS

DEALER